

9PzB 585

(2V585Ah/5HR)



Specification

Voltage Per Unit	2V(single cell)
Capacity	585Ah@5hr-rate to 1.70V per cell @25°C
Weight	Approx. without electrolyte 26.2 Kg Approx. including electrolyte 33.2 Kg
High Rate Discharge Current	585 A
Operating Temperature Range	Discharge: -40°C~60°C Charge: -20°C~50°C Storage: -40°C~60°C
Optimal Operating Temperature Range	25°C ± 5°C
Maximum Charging Current	87.8 A
Cycle charged	2.65 to 2.85 VDC/unit Average at 25°C
Self Discharge	Self-discharge ratio less than 5% per month at 25°C. Please charge batteries before using.
Terminal	D2(M10 Copper Terminals) & D4(Lead Terminals)
Dimensions (L×W×H×TH)	157mm×158mm×454mm×484mm(Total High)

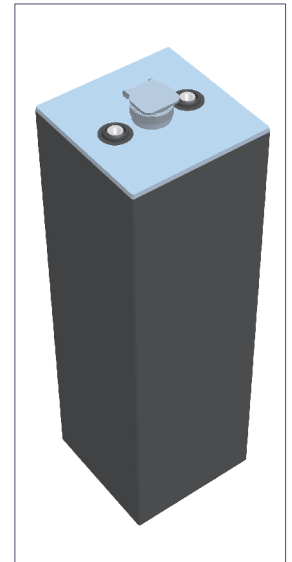

Constant Current Discharge Characteristics : A(25°C)

F.V/Time	30MIN	1HR	2HR	3HR	4HR	5HR	6HR	8HR	10HR
1.60V	554.2	388.0	224.8	168.4	137.4	123.2	106.8	83.2	68.7
1.65V	541.5	379.2	219.7	164.5	134.2	120.4	104.3	81.3	67.1
1.70V	526.3	368.6	213.5	159.9	130.5	117.0	101.4	79.0	65.2
1.75V	506.3	354.4	205.3	153.8	125.4	112.5	97.5	75.9	62.7
1.80V	483.3	338.4	196.1	146.8	119.8	107.4	93.1	72.5	59.9
1.85V	457.8	320.7	185.8	139.1	113.5	101.8	88.2	68.7	56.8

Constant Power Discharge Characteristics : W(25°C)

F.V/Time	30MIN	1HR	2HR	3HR	4HR	5HR	6HR	8HR	10HR
1.60V	1036.4	747.3	441.6	333.9	272.9	244.9	212.3	165.5	136.8
1.65V	1017.9	731.9	432.5	327.7	267.5	240.1	208.2	162.2	134.1
1.70V	1000.8	712.5	421.0	319.5	260.7	234.0	202.8	158.0	130.5
1.75V	963.3	685.4	405.0	307.2	250.7	225.0	195.0	151.9	125.4
1.80V	920.6	658.0	388.8	293.4	239.6	214.9	186.2	145.0	119.8
1.85V	877.3	628.2	371.3	278.3	227.0	203.6	176.5	137.4	113.5

Life characteristics of cyclic use

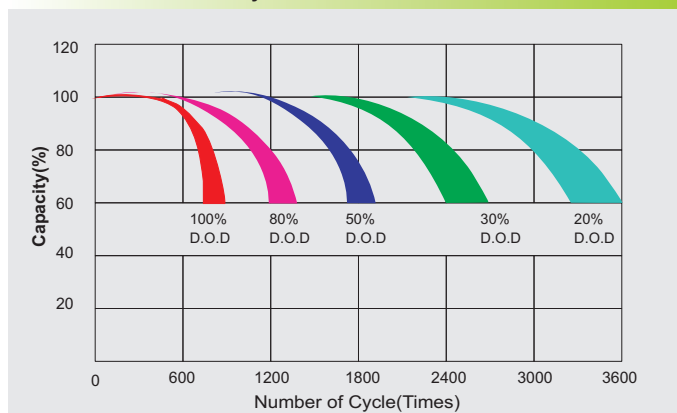

Charge characteristic Curve for cycle use

